

Modifications to Royal Enfield Motorcycle to Have Custom Motorcycle or Harley Davidson Styling

Whatever changes are made for styling purposes, it is important not to do anything that will cause unsafe riding characteristics. The list below is not a comprehensive one and there can be other alterations that could be made.

1. Increase fork rake
 - Alter frame rake and increasing it by cutting top/down tubes to remove headstock. Reshape tube ends and re-install headstock at new/greater angle
 - Manufacture new triple trees to increase rake by 3-8 degrees
 - Manufacture new triple trees that vary in rake from 0 – 15 degrees. See <http://www.tolle.se/index.php?lang=eng>
 - These changes require alterations to headlamp/speedo/wiring
 - Longer fork tubes – to be newly manufactured
 - Rake is determined to ensure correct trail for safety
 - Maintain vertical engine and horizontal bottom frame rail
 - Important to carry this out in some kind of frame jig to ensure accuracy and strength. Rider safety is paramount.
2. Frame stretch
 - This can be done with or without alteration in frame rake
 - Aim is to lengthen top frame tube and down tube(above engine mounts)
 - Cut top tube and insert new extension and reshape to marry up to headstock
 - Manufacture new downtube and reshape to marry up to headstock
 - May be possible to manufacture new front frame section(longer top/down tubes/headstock) and weld in
 - Rake is determined to ensure correct trail for safety
 - Maintain vertical engine and horizontal bottom frame rail
 - Important to carry this out in some kind of frame jig to ensure accuracy and strength. Rider safety is paramount.

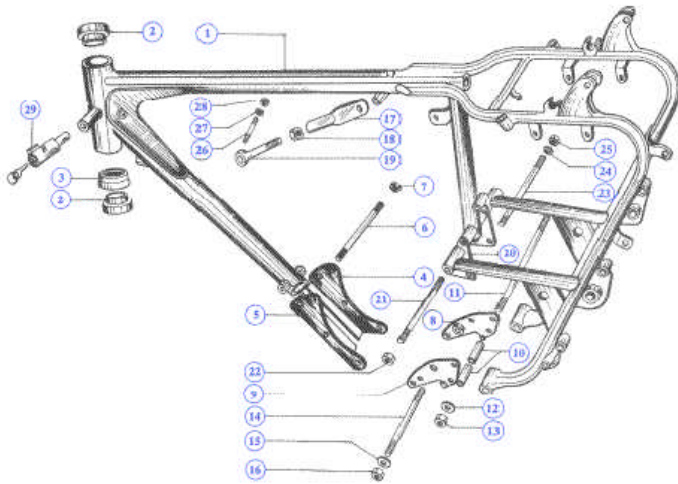

3. Front Wheel
 - The front wheel size can be increased to 21 or 23 in dia.
 - To keep costs down this should be a secondary consideration
 - Maintain vertical engine and horizontal bottom frame rail
4. Rear Wheel
 - Replace with 16in dia and wider tyre. Careful to consider new wheel/tyre together with space between rear subframe and the need to line up final chain alignment with gearbox sprocket and clearance between chain and tyre. It might be possible to manufacture a new gearbox sprocket with offset to allow more chain clearance for a wider tyre
 - Carry this out in conjunction changes with stretch and rake
 - Maintain vertical engine and horizontal bottom frame rail

5. Rear Fender
 - Make shorter by cutting length of up to 6in off end
 - If wider tyre is used the stock fender can be cut down middle and new section welded in and shape maintained
 - New fender bought or made and installed
 - see <http://www.customchrome.com/catalogs/CCP2006/1122.html> for inspiration
6. Seat
 - Remove existing seat
 - Replace with new single seat
 - Make new seat base and recover
 - See <http://www.customchrome.com/catalogs/CCP2006/t156.html> for inspiration
7. Front Fender
 - This can be left the same
 - This can be shortened
 - This can be narrowed
8. Petrol Tank
 - Tank length can be extended at rear
 - Tank must be re-styled with rear extension
 - Rear extension wont contain fuel and will be for cosmetic purposes only
 - Any changes wont alter frame mounts

Other Considerations

- Wiring
- Speedometer mounting
- Headlamp mounting. See pictures for ideas



Paint

- If customer will pay for this, then a good quality and stylish paint finish will create maximum impact

More Information

http://www.hitchcocksmotorcycles.com/index.php?page=display_books.php

Copywrite. Alistair Harley

If you have found this useful, please let us know. If there is something you feel can be added, please let us know.

Email. arharley@harleycustom.com